

# CITY OF MARICOPA

PROUD HISTORY • PROSPEROUS FUTURE

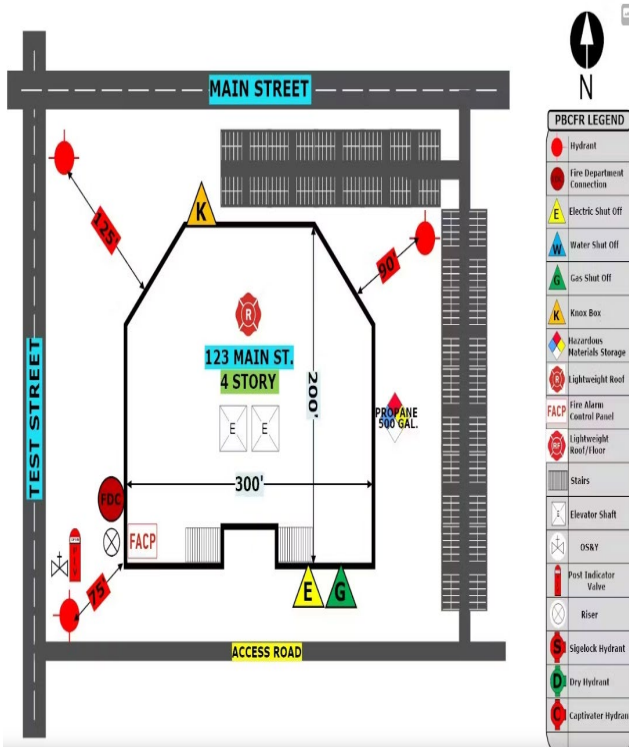

## PRE-INCIDENT FIRE PLAN

BUILDING SAFETY DIVISION  
 39700 W. Civic Center Plaza  
 Maricopa, AZ 85138  
 Ph: 520.568.9098  
 Fax: 520.568.9120  
[www.maricopa-az.gov](http://www.maricopa-az.gov)



## Pre-Incident Fire Plan

A "**Pre-Incident Fire Plan**" is a detailed document needed by outside fire departments that outlines critical information about specific buildings or sites, allowing them to quickly and effectively respond to a potential fire emergency by understanding the building layout, hazards, access points, fire suppression systems, and other relevant details before an incident occurs, ultimately aiming to minimize property damage and protect lives.

### Floor Plans:

- One plan for each building floor.
- All exterior and interior walls.
- All door locations (ingress/egress) throughout the building, including roll up doors and roof hatch/doors.
- Stairs and elevator locations.
- Room/suite's names and/or numbers.
- Utility shutoff locations (water, electric and gas).
- Special hazards and high-piled stock/racks, if any.
- Fire department items shall include, but are not limited to:
  - Standpipes
  - Fire sprinkler riser locations
  - Fire alarm panels
  - Fire department connections
  - Knox boxes
  - Fire access gates
  - Curb fire lanes

**Site Plan:** Including parking lot, building numbers, parking garages, fire lanes and fire hydrants locations.

**Roof Plan:** Layout and access (ladder/hatch locations)

**Not Required.** The drawings are not required to contain layers listing furnishings, floor coverings, ceiling styles/grids, plumbing fixtures, electrical (lights, switches, outlets), wall coverings, or landscape information.



# Typical Fire Symbology Example Template

## Project/Development Name

NOTE: 1st FLOOR = 1000 SERIES

2nd FLOOR = 2000 SERIES

3rd FLOOR = 3000 SERIES

NOTE: MAINTENANCE SHED IS LOCATED AT BLDG 7  
UNDER UNIT 2030

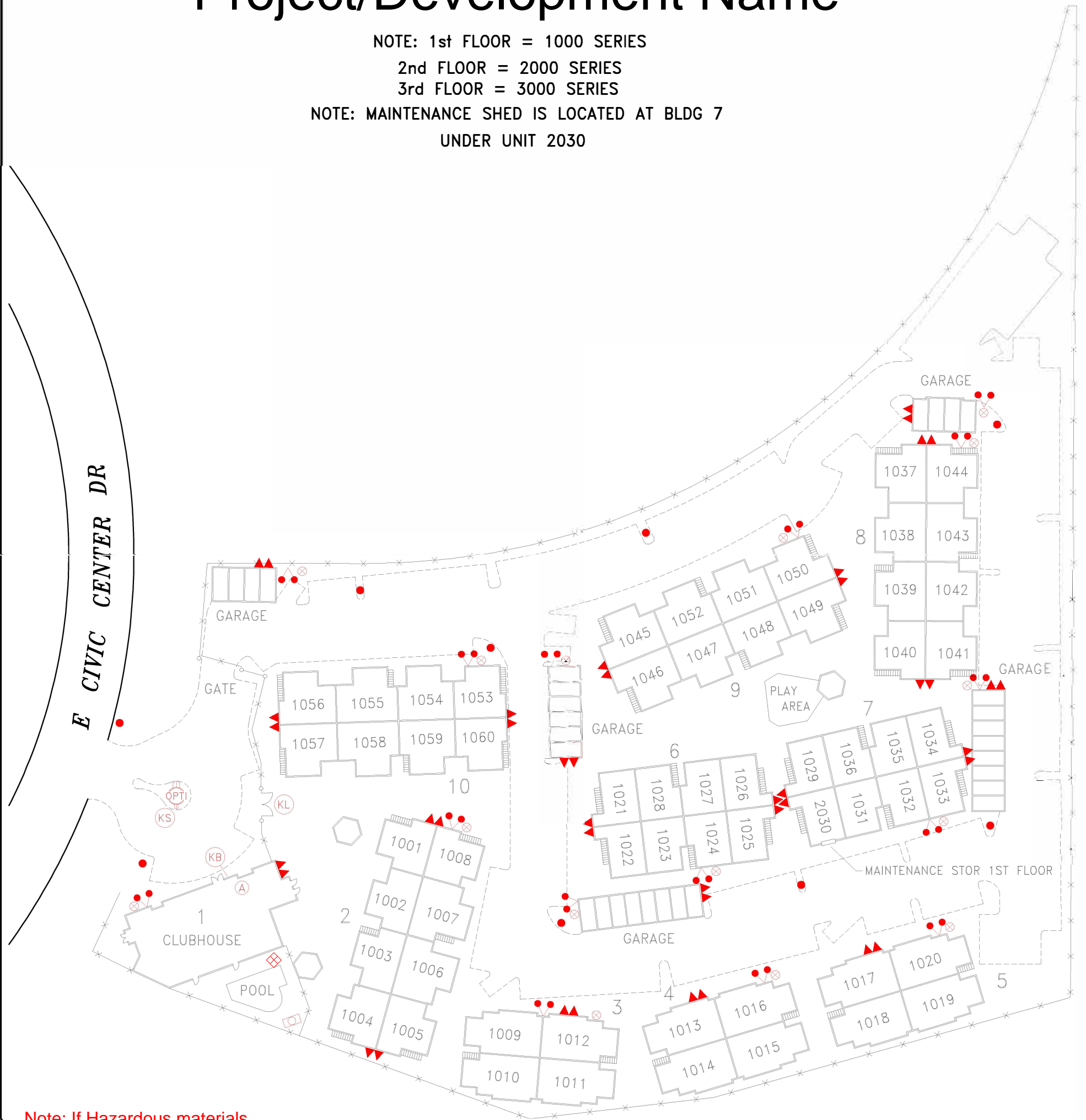

Note: If Hazardous materials exist on property, mark the location and what the material is.



### FIRE SYMBOLOGY

	ANNUNCIATOR PANEL		HALON SYSTEM		POST INDICATOR VALVE
	ELECTRICAL SHUTOFF		HAZARDOUS MATERIALS		PRE-EMPTION SWITCH
	ELEVATOR		HYDRANT		RISER SHUTOFF
	FIRE ALARM CONTROL PANNEL		KNOX BOX		ROLL-UP DOORS
	FIRE DEPT. CONNECTION		KNOX PADLOCK		STAIRS
	FDC - STORTZ		KNOX SWITCH		STANDPIPE
	GAS SHUTOFF		OUTSIDE STEM & YOKE		TANK
					UNDERGROUND TANK



**TYPE OF RISK OCCUPANCY**

- MAXIMUM       HIGH
- MEDIUM       SPECIAL

SEE DEFINITIONS ON BACK PAGE

- PREPLAN     APARTMENT     TRAILER     GOLF     SCHOOL

SITE NAME: \_\_\_\_\_

ADDRESS: \_\_\_\_\_

**SITE SURVEY**

FDC:     YES     NO

STD PIPE:     WET     DRY     NONE

LOCATION(S): \_\_\_\_\_      LOCATION(S): \_\_\_\_\_

SPRINKLER SYSTEM:     FULL     PARTIAL     ATTIC     BASEMENT     NONE      # OF SYSTEMS: \_\_\_\_\_

SHUTOFF LOCATION(S): \_\_\_\_\_

ELECTRICAL SHUTOFF LOCATION(S): \_\_\_\_\_

GAS SHUTOFF LOCATION(S): \_\_\_\_\_

FENCE:     CHAIN LINK     MASONRY     WOOD     WROUGHT IRON     OTHER: \_\_\_\_\_     NONE      HEIGHT: \_\_\_\_\_

**KNOX DEVICES:**

KNOX BOX:     YES     NO      # OF BOXES: \_\_\_\_\_

KNOX PADLOCK:     YES     NO      # OF LOCKS: \_\_\_\_\_

LOCATION(S): \_\_\_\_\_

LOCATION(S): \_\_\_\_\_

KNOX SWITCH:     YES     NO      # OF SWITCHES: \_\_\_\_\_

KNOX PRE-EMPTION:     YES     NO      # OF DEVICES: \_\_\_\_\_

LOCATION(S): \_\_\_\_\_

LOCATION(S): \_\_\_\_\_

HAZMAT:     YES     NO    SPECIFY: \_\_\_\_\_

**CONSTRUCTION SURVEY**

DIMENSIONS    HEIGHT: \_\_\_\_\_    WIDTH: \_\_\_\_\_    LENGTH: \_\_\_\_\_      # OF FLOORS \_\_\_\_\_    BASEMENT:     YES     NO

**WALL CONSTRUCTION**

- MASONRY
- WOOD-FRAME
- METAL
- CONCRETE
- SEE NOTES

**ROOF DESIGN**

- FLAT
- PITCH
- ARCH
- W/ PARAPET HGT: \_\_\_\_\_
- SEE NOTES

**TRUSS TYPE**

- PANELIZED,  
PURLIN TYPE \_\_\_\_\_
- LIGHTWEIGHT TRUSS
- WOOD I-BEAM
- WOOD W/ METAL WEB
- WOOD W/GUSSET
- WOOD GABLE
- CONVENTIONAL JOIST
- STEEL BAR JOIST
- CONCRETE JOIST
- SEE NOTES

**SHEATHING/DECKING**

- PLYWOOD
- O.S.B.
- METAL
- CONCRETE
- SEE NOTES

**ROOF COVERING**

- ASPHALT SHINGLE
- TILE
- SHAKE
- METAL
- FOAM
- CONCRETE
- ROLLED
- SEE NOTES

BEST ROOF ACCESS  
LOCATION: \_\_\_\_\_

NATURAL VENTILATION  
LOCATION/TYPE: \_\_\_\_\_

ROOF LOADING  
LOCATION/TYPE: \_\_\_\_\_

SPECIAL NOTES/HAZARDS: \_\_\_\_\_

\_\_\_\_\_

\_\_\_\_\_

**TYPE OF RISK OCCUPANCY:**

**MEDIUM RISK**

- A - ASSEMBLY < 100 OCC.
- F - FACTORY W/O SPECIAL PROCESS
- S - STORAGE(S1)
- R1 - RESIDENTIAL
- R2 - RESIDENTIAL
- M - MERCANTILE 12,000-50,000 SQ. FT.
- B - BUSINESS 12,000-50,000 SQ. FT.
- OCCUPANCY W/HOOD < 50 OCC.

**EXAMPLES:**

HOTELS, APARTMENTS, SOME STORAGE FACILITIES, ASSEMBLIES NOT CLASSIFIED AS HIGH RISK, FAST FOOD OR SMALLER RESTAURANTS.

**MAXIMUM RISK**  (BLUE)

- NON-SPRINKLED OCCUPANCIES (3 OR MORE STORIES)
- HOSPITALS
- HIGHRISE/MIDRISE COMPLEX SPRINKLED OR NOT
- WAREHOUSES W/HEAVY FIRE LOAD
- EXPLOSIVE MANUFACTURING
- SEMI-CONDUCTOR INDUSTRIES
- OCCUPANCIES W/EXTREME TOXIC MATERIALS
- NON-SPRINKLED NURSING HOMES
- ASSEMBLIES W/>50 AND JAILS
- UNPREPLANNED VACANT BUILDINGS
- UNPREPLANNED DOWNTOWN COMMERCIAL OCCUPANCIES

**HIGH/SPECIAL RISKS**  (BLUE)

- "H" OCCUPANCIES (FLAMMABLE SOLIDS/ HIGH PHYSICAL HAZARD)
- LARGE REPAIR GARAGES/SHOPS/AIRCRAFT HANGERS
- SPRINKLED SHOPPING MALLS, THEATERS, RESTAURANTS
- LARGE ASSEMBLY W/OCCUPANT LOAD OVER 1,000 AND A STAGE
- LARGE ASSEMBLIES < 1,000 AND > 300 PEOPLE
- STADIUMS AND AMUSEMENTS PARKS
- SPRINKLED NURSING HOMES/NURSERIES W/FULL TIME CARE OF CHILDREN UNDER 6
- SPRINKLED MENTAL INSTITUTIONS/JAILS
- LARGE FACTORIES OR INDUSTRIAL OCCUPANCIES OF MODERATE HAZARD
- SCHOOLS (PUBLIC, CHARTER, PAROCHIAL)

---

**HAVE THE FOLLOWING BEEN INCLUDED ON THE SITE PLAN?**

- |  |   |
|--|---|
| <input type="checkbox"/> AT LEAST ONE STREET                 | <input type="checkbox"/> POOL AREAS                     |
| <input type="checkbox"/> AT LEAST 2 HYDRANTS AND DISTANCES   | <input type="checkbox"/> RESTRICTED VEHICLE ACCESS      |
| <input type="checkbox"/> ALL FD CONNECTIONS                  | <input type="checkbox"/> ANY FENCES AND HEIGHTS         |
| <input type="checkbox"/> SHUTOFFS (SPRINKLER/GAS/ELECTRICAL) | <input type="checkbox"/> HAZARDOUS MATERIALS IDENTIFIED |
| <input type="checkbox"/> KNOX BOX DEVICE LOCATIONS           | <input type="checkbox"/> NORTH ARROW                    |